

PROPOSED VARIATION TO CONSENT Nos 19/03841/FUL  
AND 21/01717/FUL FOR A CAFE CLASS 3  
TO FORM A SMALL WINDOW EXTENSIONS

**JTA** PLANNING DRG No5  
John Todd Associates  
ARCHITECTS  
EDINBURGH

JOHN A TOD Dip Arch  
Registered Architect  
Tel: 0131-625 8147  
Email: todyoung@btinternet.com  
60 Edinburgh Road  
Musselburgh  
East Lothian  
Scotland EH21 0EE

84 JOPPA ROAD  
EDINBURGH EH15. 2ET.  
JOPPA ROCKS  
FOR H. MURDOCHY.

PROPOSED GROUND FLOOR PLAN

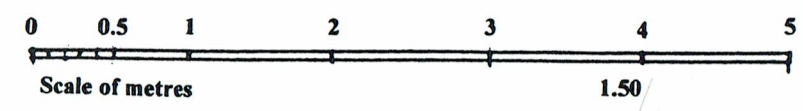
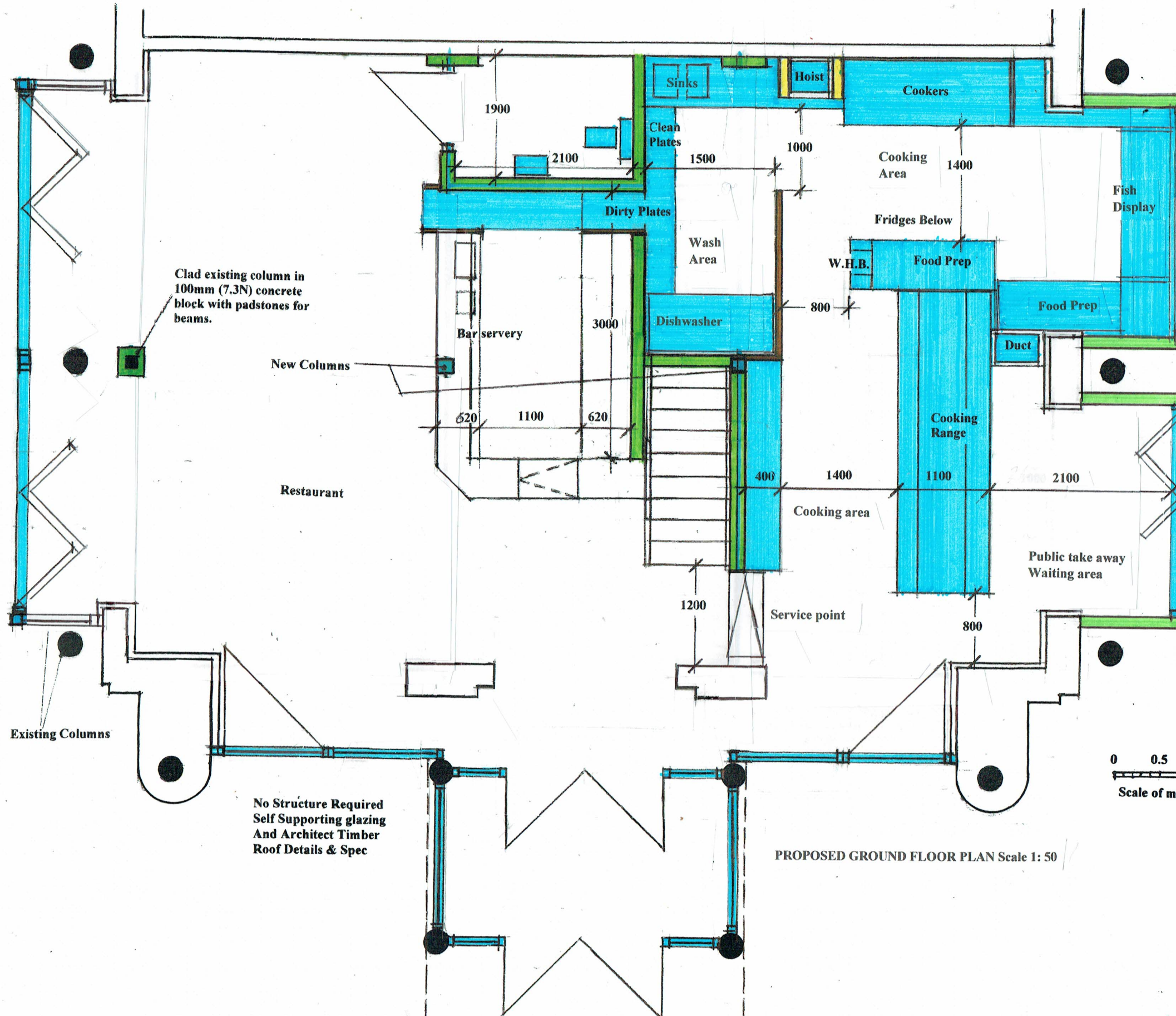

PROPOSED GROUND FLOOR PLAN Scale 1: 50

No Structure Required  
Self Supporting glazing  
And Architect Timber  
Roof Details & Spec